

# Hamilton Manufacturing Corp.

1026 Hamilton Dr. Holland, OH 43528 • Phone: 419-867-4858/800-837-5561 • Fax: 419-867-4857 • [www.hamiltonmfg.com](http://www.hamiltonmfg.com)

## Environmental Control Transformer Retrofit Kit Instructions Kit #100-0160

### Tools

Socket wrench  
Extension  
7/16" socket  
5/16" thin walled socket  
Pliers

### Instructions

1. Turn off and disconnect power to ACW G/L.
2. Twist hopper to the left, tilt hopper forward, unplug harness and remove hopper.
3. Unplug the Voice and Proximity harness from Voice module.
4. Then remove the two 8-32 screws from voice module and front panel. Remove Voice module, along with the front panel and save the hardware for reuse. See diagram below.

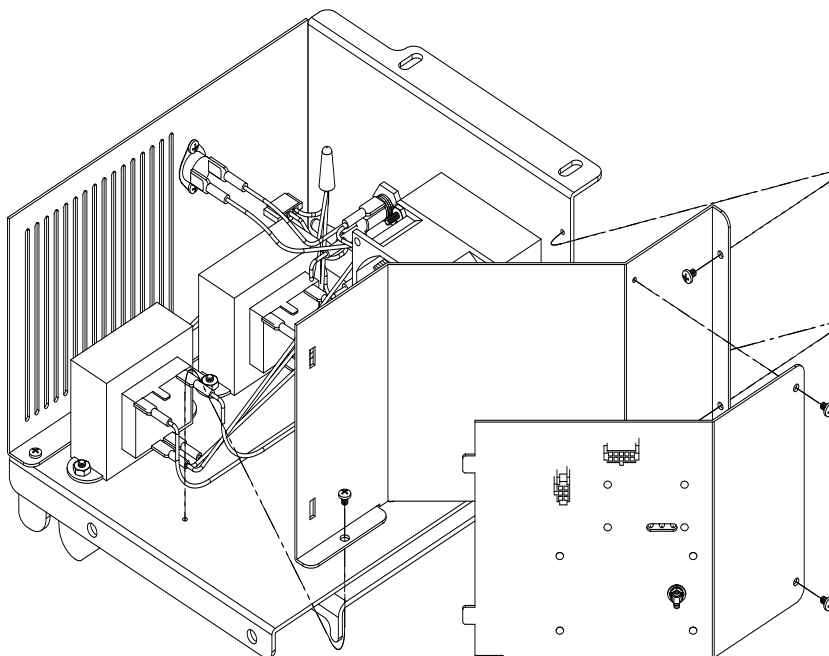

5. Using 7/16" socket remove (4) 1/4x20 nuts and 1/4 lockwashers holding environmental control in place. Save the hardware for reusing.
6. Lift the environmental controller up and toward the front of the cabinet. This should just be enough to reach behind the environmental controller to unplug the two harnesses that are connected.

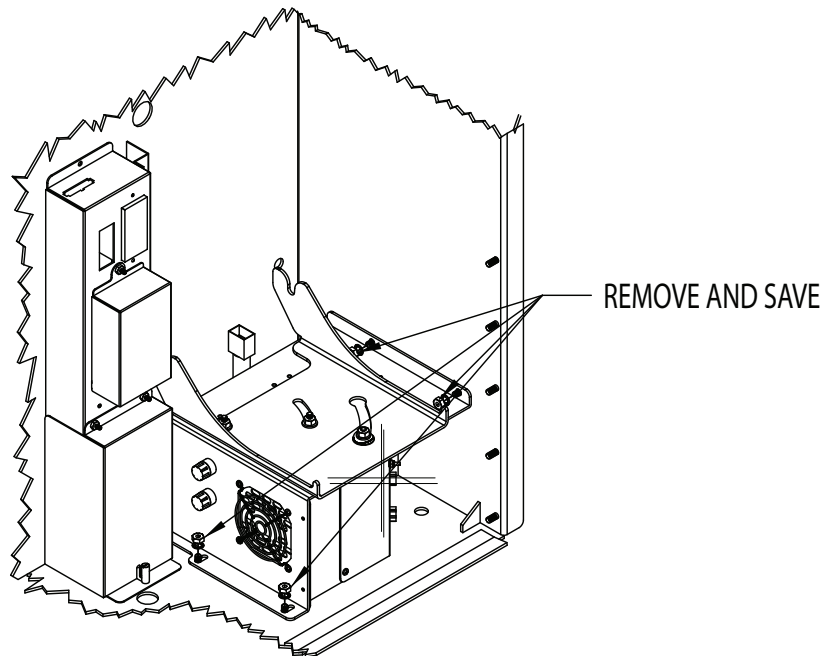

7. Place unit in the upside down position on a table using wooden blocks to keep level and steady, (Any item that will provide stability will be appropriate for this).
8. Unplug transformer 1 from unit . Please note position of wire connection.

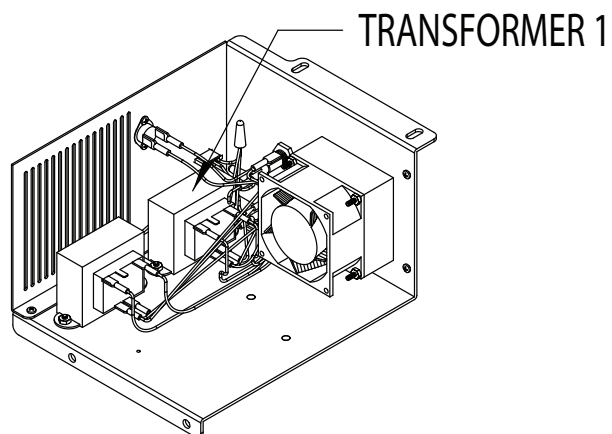

SHOWN WITH FRONT WALL AND VOICE MODULE REMOVED

9. Remove (2) 8-32x5/16 nuts holding transformer and remove.

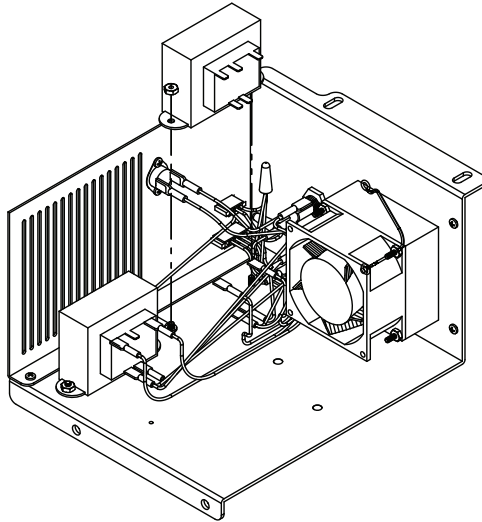

SHOWN WITH FRONT WALL AND VOICE MODULE REMOVED

10. Place larger transformer mounted to plate on studs as shown below. Using #8-32x5/16 nuts provided, tighten down transformer.

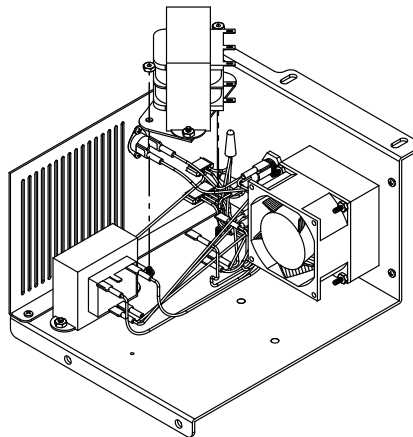

SHOWN WITH FRONT WALL AND VOICE MODULE REMOVED

11. Reconnect transformer in same orientation as original. See diagram below.

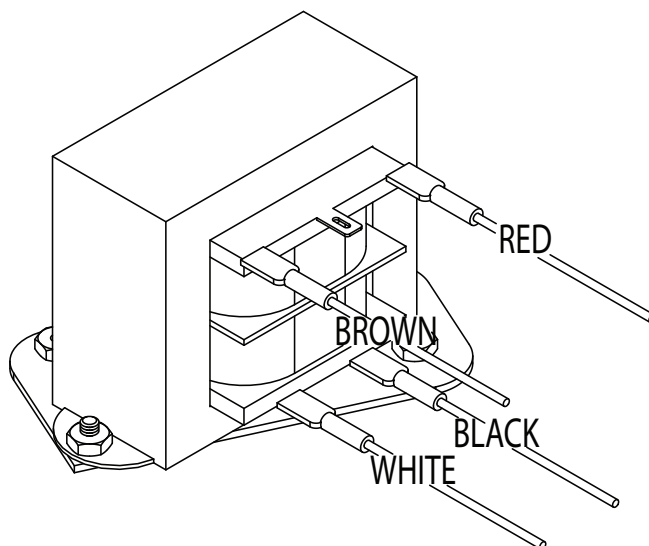

12. Re-install front panel and voice module with saved hardware
13. Place the environmental controller back in cabinet to where you can reconnect the two harnesses to the environmental controller.
14. Install environmental controller back in ACW G/L.
15. Using the saved hardware, secure the environmental control with the 1/4x20 nuts and the 1/4 lockwashers.
16. Reconnect the voice and proximity harnesses to voice module.
17. Replace hopper. Note: Do not forget to plug harness back into hopper.
18. Restore power to the ACW G/L.